

序号 No.	熔断体型号 Models				额定电压 (V) Rated voltage	额定电流 (A) Rated current	外形尺寸(mm)Outline dimension(mm)											重量 (g) Weight
	本公司 JINSHAN		国内外同类产品 Cross-reference				图号 Fig	A	B	C	ΦD	E	F	H	Φd			
	普通(gG)	快速(aR)	普通(gG)	快速(aR)														
D0197	RG1	RGS1	TIA	-	500	4~35	13.2	54	73	85	22	9.5	1.5	25	5.5×7.5	55		
D0198	RG3	RGS3	-	-	500	6~63	13.2	54	73	85	22	9.5	1.5	25	5.5×7.5	51.1		
D0199	RG4	RGS4	-	GSG	660/1000	10~63	13.2	48	63	77	16.5	12	2.0	18	6.5×9	32		
D0200	RG6	RGS6	-	GSA	500	80	13.2	68	93	112	31	19	2.0	33	9×11.5	146		
D0201	RG7	-	TCP	-	500	100	13.2	68	95	116	34	19	2.0	35	9×11.5	228		
D0202	RG7A	RGS7A	-	PC10D	500	110~150	13.2	57	99	119	38	24	3.0	40	5	178		
D0203	RG11	RGS11	-	CR2.GSB	250/380	16~75	13.2	27.5	42	56	16.5	12	2.0	18	6.5×9	25		
D0204	RG12	RGS12	-	CR2.GSB	250/500	75~175	13.2	31.5	58	80	26	19	3.0	27	9×11.5	79.5		
D0205	RG14	RGS14	-	GSB	500	5~20	13.2	31	37	46	8.5	7	0.8	9.5	4.5×6	55		
D0206	RG14B	RGS14B	-	GSB	500	5~20	13.2	54	64	73	8.5	7	0.8	9.5	4.5×6	8.5		
D0207	RG15	RGS15	-	CR2.GSB	250/500	200	13.2	34	60	88	30	25	3.0	36	11×13	120		
D0208	RG17	RGS17	-	GSB	500	40~100	13.2	54	78	96	22.2	20.5	2	24	9×12	62.3		
D0209	RG18	RGS18	-	CR6L	600	75~150	13.2	40	70	95	30	25	3.2	33	11×13	147		
D0210	RG19	RGS19	-	CR6L	600	200~250	13.2	43	82	107	37	30	4.0	42	11×13	219		
D0211	RG0H	-	AAO		500	2~32	13.2	34	72	84	13.5	9.4	1.2	15	5.5×7.8	18		
D0212	RG4AD	RGS4AD	-	250GH	250	32~160	13.2	29	56	77	23.8	20	3	25.5	9×14	39		
D0213	RG4A	RGS4A	-	660GH	660	125~200	13.2	50	77	98	23.8	20	3	25.5	9×14	53		
D0214	RG4B	RGS4B	-	660GH	660	225~315	13.2	50.5	82	108	31	25	3	34	10.5×16	75		

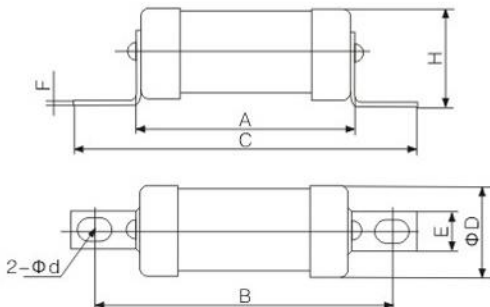

## 用途 Applications

本系列熔断体适用于交流50Hz, 额定电压至1200V、额定电流至630A的电气装置中, 有三种结构不同的熔体, 一种作为电气线路的过载和短路保护(gG); 另一种作为半导体器件及其成套装置的短路保护(aR); 还可派生为电动机短路保护(aM)。

本系列熔断体额定分断能力至80KA。

本系列熔断体符合国家标准GB13539和国际电工委标准IEC60269。

This series of fuse-links for the exchange of 50Hz, rated voltage to 1200V, rated current to 630A electrical devices, there are three Different kinds of structure melt, an electrical circuit as overload and short circuit protection(gG); the other as a set of semiconductor devices and their Short-circuit protection device(aR); can be derived for the electrical short-circuit protection(aM).

This series of fuse-links to the rated breaking capacity 80KA.

This series of fuse in line with the national standards body and international electricity Work Gb13539 standard IEC60269.

## 结构特点 Design Features

由纯铜片/银片(或丝)制成的变截面熔体封装于由高强度瓷或环氧玻璃布管制成的熔管内, 熔管中充满经化学处理过的高纯度石英砂作为灭弧介质。熔体二端采用点焊与端帽(或触刀连接板)牢固电连接。熔断体可带有撞击器, 当熔断体熔断时, 撞击器立即动作, 推动微动开关, 发出各种信号以及自动切换电路。

By the pure copper film/silver film(or wire)into the variable cross-section of high melt strength by package porcelain or epoxy glass cloth control tube into the melt, the melting Tube filled with chemically treated high-purity quartz sand as arc-quenching medium. Second, the use of melt-side spot with the end caps(or touch Connection board knife)Solid electrical connections. Can fuse with the impactor body, when the fuse body, the impactor immediate action to promote the micro-switch, the issue of a variety of signal and automatic switching circuit.

## 基本数据 Basic Data

熔断体型号、外型尺寸、额定电压、额定电流见图 13.1~13.7。

The models, dimensions, ratings are shown in Figures 13.1~13.7.