

熔断体型号 Models					尺码	额定电压 (V)	额定电流 (A)	外形尺寸(mm)Outline dimension(mm)					重量 (g)
序号	本公司 JINSHAN		国内外同类产品 Cross-reference					图号	ΦA	ΦC	ΦD	L	
No.	普通(gG) Normal	快速(aR) Fast	普通(gG) Normal	快速(aR) Fast	Size	Rated voltage	Rated current	Fig					Weight
D0019							2~6	5.5	6	22	13.5	48.5	
D0020							8~10	5.5	8	22	13.5	48.5	
D0021	RO21	RS21	5SB E27				13	5.5	8	22	13.5	48.5	24.8
D0022			RL6-25	5SD	D II	500	16	5.5	10	22	13.5	48.5	
D0023			RL93				20	5.5	12	22	13.5	48.5	
D0024							25	5.5	14	22	13.5	48.5	
D0025			5SB E33				30~40	5.5	16	27	20	50	48.1
D0026	RO22	RS22	RL6-63	5SD	D III	500	50	5.5	18	27	20	50	
D0027			RL93				63	5.5	20	27	20	50	
D0028							2~6	5.5	6	12.5	11.3	50	11.7
D0029	RO24	RS24	E16	-	-	500	10	5.5	8	12.5	11.3	50	
D0030			5SA				16	5.5	10	12.5	11.3	50	
D0031								20~25	5.5	12	12.5	11.3	
D0032	RO27	RS27	BLA	BLC	-	600	3~10	5.5	8	12.5	11.5	50	13.1
D0033	RO28	RS28	BLA	BLC	-	600	15~20	5.5	10	12.5	11.5	50	14.5
D0034	RO29	RS29	BLA	BLC	-	600	25~40	5.5	14	12.5	11.5	50	16.4

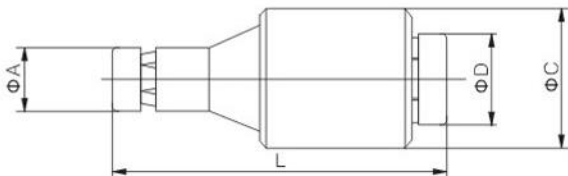

用途 Applications

本系列熔断体适用于交流50Hz、额定电压至600V、额定电流至630A，主要用在电气装置中作线路过载和短路保护（gG/gL）；还可派生为半导体器件及其成套装置的短路保护（aR）以及电动机短路保护（aM）。

本系列熔断体额定分断能力至50KA。

本系列熔断体符合国家标准GB13539和国家电工委标准IEC60269。

Protection against overload and short-circuit in electric lines(type gG/gL),also available for protection of semiconductor parts and equipments against short-circuit(type aR)and protection of motors(type aM).

Rated voltage up to 600V; Rated current up to 630A; Rated breaking capacity up to 50KA. Compliant with GB13539 and IEC60269.

结构特点 Design Features

由纯铜/银（或丝）制成的变截面熔体封装于由高强度瓷制成的熔管内；熔管中充满经化学处理过的高纯度石英砂作为灭弧介质。熔断体端帽上有熔断指示器，当熔断体熔断时，指示器立即弹出，显示熔断体已熔断。

Variable cross-section fuse element made from pure metal sealed in cartridge made from high-duty ceramic.Fuse tube filled with chemically treated high-purity quartz sand as arc-extinguishing medium.Indicator springs out when fuse cuts to give caution.

基本数据 Basic Data

熔断体型号、外形尺寸、额定电压、额定电流见图5.1~5.6及表5。

The models,dimensions,ratings are shown in Figures5.1~5.6 and Tables 5.

特性曲线 Characteristics Curve

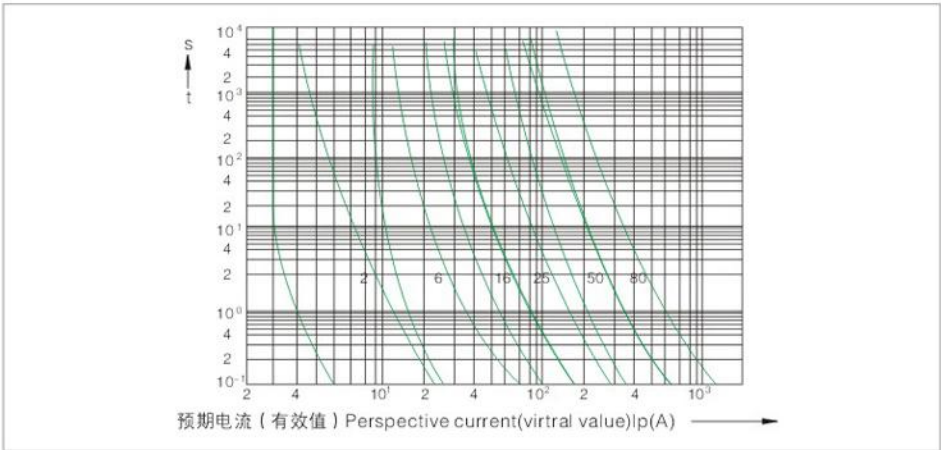

"gG"熔断体的时间-电流带 Time-current range of "gG"fuse links

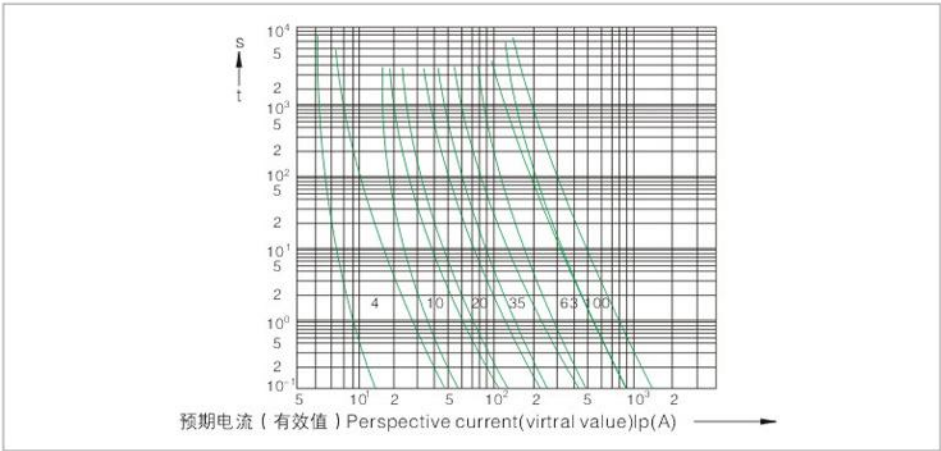

"gG"熔断体的时间-电流带 Time-current range of "gG"fuse links

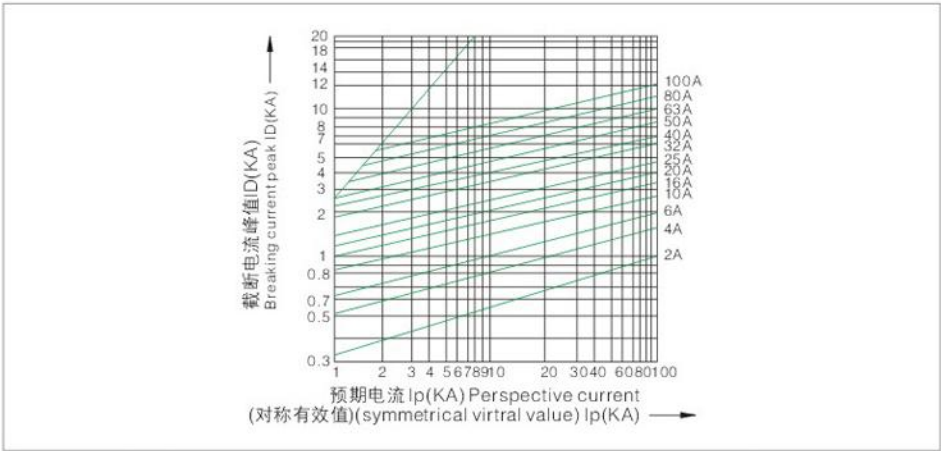

"gG"熔断体的截断电流特性曲线 Breaking current characteristics curve of "gG" fuse links