

熔断体型号Models

序号 No.	熔断体型号Models				额定电压 (V)	额定电流 (A)	外形尺寸(mm) Outline dimension(mm)		重量 (g)
	本公司 JINSHAN		国内外同类产品 Cross-reference				图号 Fig	ΦD×L	
	普通(gG) Normal	快速(aR) Fast	普通 Normal	快速 Fast	Rated voltage	Rated current			
D0047	R006	RS06	-	-	250/380	1~32	7.1	Φ12.7×29	6.5
D0048	R007	RS07	-	-	600	10~100	7.1	Φ30×57	75
D0049	R009	RS09	-	-	500	2~63	7.1	Φ18×37	17.4
D0050	R010	RS10	-	-	500	2~63	7.1	Φ18×50	23.5
D0051	R011	RS11	AJTJKSLPJ	ACL	600	2~63	7.1	Φ21×58	51.5
D0052	R012	RS12	AJTJKSLPJ	ACL	600	35~100	7.1	Φ27×60	90
D0053	R013	RS13	-	-	500	2~40	7.1	Φ15×50	23.2
D0054	R014	RS14	RT19-16gF1	-	500	0.5~20	7.1	Φ8.5×31.5	4.4
D0055	R014A	RS14A	-	-	250	0.5~20	7.1	Φ8.5×23	3.5
D0056	R014B	RS14B	-	-	380/500	0.5~20	7.1	Φ8.5×36	5.0
D0057	R015	RS15	RT14-20 gF2 RT18-32 RT19-25	KTG KLM	380/500	0.5~32	7.1	Φ10.3×38	7.7
D0058	R015A	RS15A	-	-	250	0.5~16	7.1	Φ10.3×25.8	4.8
D0059	R015B	RS15B	-	-	250/500	0.5~25	7.1	Φ10.3×31.5	5.8
D0060	R015C	RS15C	-	-	380/500	0.5~32	7.1	Φ10.3×34	6.2
D0061	R015D	RS15D	-	-	600	2~32	7.1	Φ10.3×57	11
D0062	R016	RS16	RT14-32 gF3RT18-63 RT19-40	EWP	380/660	2~50	7.1	Φ14.3×51	20.5
D0063	R016A	RS16A	-	-	500	2~50	7.1	Φ14.3×38	15.6
D0064	R016B	RS16B	-	-	500	2~50	7.1	Φ14.3×45	18.5
D0065	R016C	RS16C	-	-	500	2~50	7.1	Φ14.3×67	27.5
D0066	R017	RS17	RT14-63 gF4RT18-125 RT19-100	URE2263	380/660	10~125	7.1	Φ22.2×58	58
D0067	R018	RS18	-	-	380	0.5~25	7.1	Φ9.6×30	4.8
D0068	R019	RS19	FRS TRS FLSR	-	600	0.5~32	7.1	Φ20.5×127	91.2
D0069	R019A	RS19A	FLNR Pc2	-	250/500	0.5~63	7.1	Φ20.5×76	63
D0070	R019B	RS19B	-	-	600	0.5~32	7.1	Φ20.5×114	85
D0071	R019C	RS19C	FRS TRS FLSR	-	600	32~63	7.1	Φ27×139	172.4
D0072	R019D	RS19D	-	-	600	32~63	7.1	Φ27×147	160
D0073	R054	RS54	-	-	250	0.5~16	7.1	Φ5×20	1
D0074	R055	RS55	-	-	250	0.5~16	7.1	Φ5×25	1.3
D0075	R056	RS56	-	-	250	0.5~16	7.1	Φ5×20	1.7
D0076	R057	RS57	-	-	250	0.5~16	7.1	Φ6.3×25	2.1
D0077	R058	RS58	-	-	250/500	0.5~16	7.1	Φ6.3×31.5	2.5

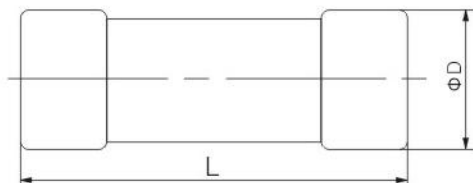

## 用途 Applications

本系列熔断体适用于交流50Hz、额定电压至660V、额定电流至125A，主要作为电气线路的过载和短路保护（gG），还可派生为半导体器件及其成套装置的短路保护（aR）以及电动机短路保护（aM）。

本系列熔断体的额定分断能力至100KA。

本系列熔断体符合国家GB13539和国际电工委标准IEC60269。

Protection against overload and short circuit in electric lines (type gG), also available for protection of semiconductor parts and equipments against short-circuit (type aR) and protection of motors (type aM).

Rated voltage up to 660V; Rated current up to 125A; Working frequency 50Hz AC; Rated breaking capacity up to 100KA. Compliant with GB13539 and IEC60269.

## 结构特点 Design Features

由纯铜/银片（或丝）制成的变截面熔断体封装于由高强度瓷或环痒玻璃布管制成的熔管内；熔管中充满经化学处理过的高纯度石英砂作为灭弧介质；熔体二端采用点焊与端帽牢固电连接。熔断体可带有撞击器，当熔体熔断时，撞击器立即动作，推动微动开关，发出各种信号或自动切换电路。根据用户需要，还可派生图7.2所示的特殊熔断体。

本系列熔断体呈插入式结构，按尺码可配装于RT14、RT18、RT19以及其它相应尺码的熔断体支持件。

Variable cross-section fuse element made from pure metal sealed in cartridge made from high-duty ceramic or epoxy glass. Fuse tube filled with chemically treated high-purity quartz sand as arc-extinguishing medium. Dot-welding of fuse element ends to the caps ensures reliable electric connection; Striker may be attached to the fuse links to provide immediate activation of micro-switch to give various signals or cut the circuit automatically. Special fuse as per Figure 8.2 can be supplied according to customers requirements.

The series fuse links has insert type structure and can be equipped with RT14、RT18 and RT19 according to sizes and other fuse links supporters of corresponding sizes.

## 基本数据 Basic Data

熔断体型号、外形尺寸、额定电压、额定电流见图7.1~7.2及表7。

The models、dimensions、ratings are shown in Figures 7.1~7.2 and Table 7.

## 特性曲线 Characteristics Curve

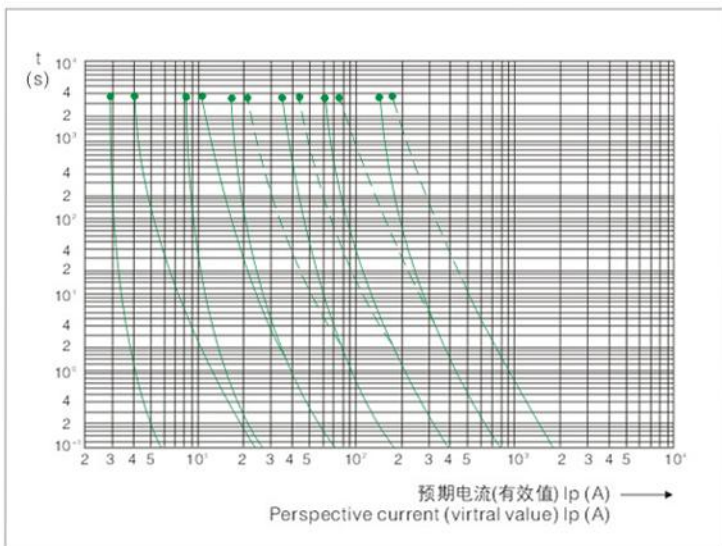

"gG"熔断体的时间——电流带  
Time-current range of "gG" fuse links

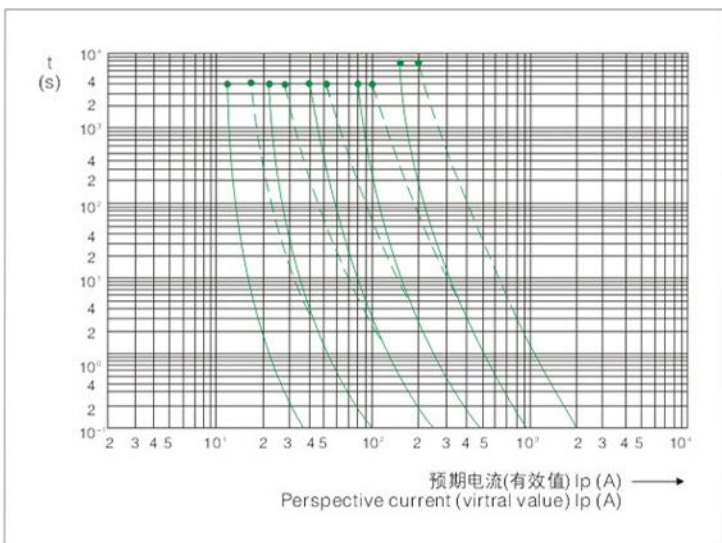

"gG"熔断体的时间——电流带  
Time-current range of "gG" fuse links

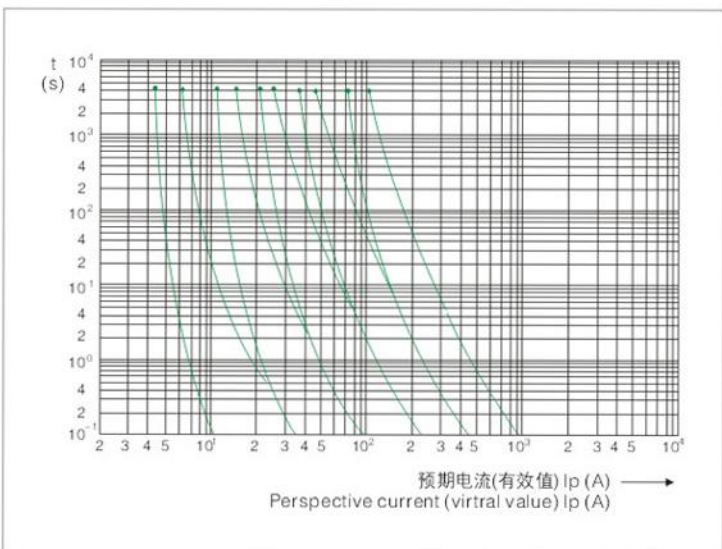

"gG"熔断体的时间——电流带  
Time-current range of "gG" fuse links

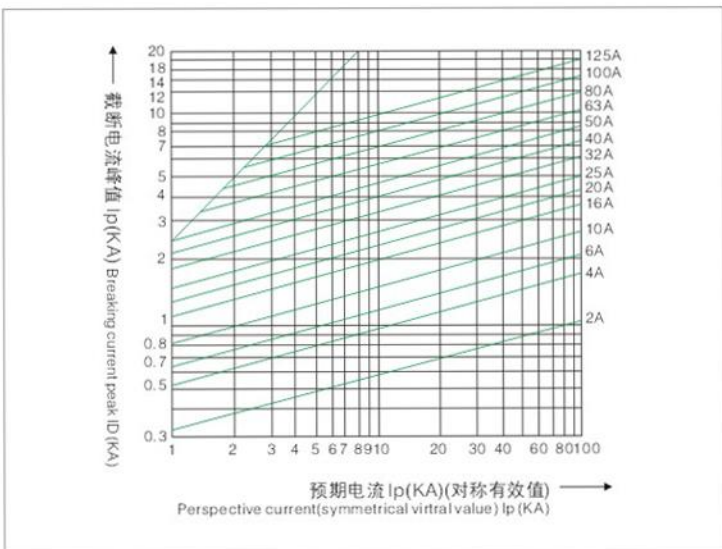

"gG" 熔断体的载断电流特性曲线  
Breaking current characteristics curve of "gG" fuse links